

## Model: **SB-P/SB-PH** Dryer Vent

- Standard with Back-Draft Flapper Damper
- With Heavy Duty 8.6" Long Aluminum Pipe
- Large Free Area Reduces Clogging
- Ø3/16" Mounting Holes (SB-PH)

- Material: Aluminum
- Standard Finish: Clear Anodized

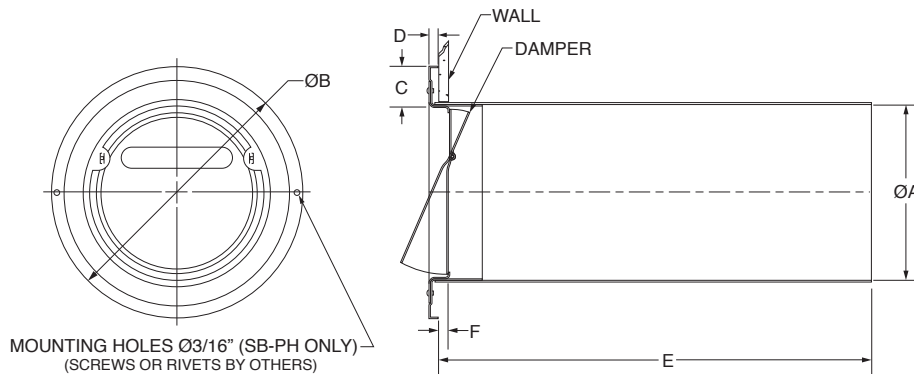

MOUNTING HOLES Ø3/16" (SB-PH ONLY)  
(SCREWS OR RIVETS BY OTHERS)

MODEL	A	B	C	D	E	F	FREE AREA
SB 4P/SB 4PH	4	5 3/4	1 7/8	9/32	8 1/2	7/32	0.059 sq.ft.
SB 6P/SB 6PH	6	7 3/4	1 7/8	9/32	8 1/2	1/2	0.140 sq.ft.

Product information is subject to change without notice. All dimensions in inches.

JOB NAME: _____	SUBMITTED BY: _____	DATE: _____	<b>Model SB-P/SB-PH</b> Dryer Vent
LOCATION: _____			
ARCHITECT: _____			
ENGINEER: _____			
CONTRACTOR: _____			