



CURRENTLY  
ONLY  
AVAILABLE  
IN CANADA

# MCS & MCSA SERIES

High stand industrial mancoolers designed to provide cooling effects to large open areas

## PERFORMANCE SPECIFICATIONS

MCS STEEL FAN BLADE						
FAN SIZE	MODEL		RPM	HP	MCS CFM	dBA @ 5 Ft
	SINGLE PHASE	THREE PHASE				
18"	MCS18T10033C	MCS18T30033C*	1140	1/3	2654	64
	MCS18T10050B	MCS18T30050B*	1750	1/2	4016	74
24"	MCS24T10075C	MCS24T30075C*	1140	3/4	6549	73
	MCS24T10100B	MCS24T30100B*	1750	1	6761	81
	MCS24T10300B	MCS24T30300B*	1750	3	9909	84
30"	--	MCS30T30150C*	1140	1 1/2	11600	79
	MCS30T10500B	MCS30T30500B*	1750	5	17552	90
36"	--	MCS36T30200D*	860	2	16364	80
	--	MCS36T30500C*	1140	5	21692	88
42"	--	MCS42T30500D*	860	5	24499	85
	--	MCS42T30500C*	1140	5	23209	88
48"	--	MCS48T30750D*	860	7 1/2	35654	89
	--	MCS48T30750C*	1140	7 1/2	32563	92

## FEATURES

- Drums and motor supports are constructed of heavy gauge steel.
- TEFC continuous duty, ball bearing motors are standard.
- All models are direct drive and available with steel blades or cast aluminum blades.
- Heavy duty, concentric circle, OSHA wire guards are standard on all sizes.
- Consult factory for availability of explosion-proof motors.
- Casters and lift handle are standard, allowing easy maneuverability.
- Fan flow direction on the tube section can easily be rotated 180°.

 **Non-stock, made-to-order products are non-returnable and cannot be cancelled.**

MCSA CAST ALUMINUM BLADE						
FAN SIZE	MODEL		RPM	HP	MCSA CFM	dBA @ 5 Ft
	SINGLE PHASE	THREE PHASE				
18"	MCSA18T10033C	MCSA18T30033C*	1140	1/3	2990	60
	MCSA18T10075B	MCSA18T30075B*	1750	3/4	4590	71
24"	MCSA24T10100C	MCSA24T30100C*	1140	1	6520	69
	MCSA24T10300B	MCSA24T30150B*	1750	1 1/2	7660	72
30"		MCSA24T30300B*	1750	3	11500	79
	MCSA30T10100C	MCSA30T30100C*	1140	1	8680	69
	--	MCSA30T30150C*	1140	1 1/2	11800	73
36"	MCSA30T10300B	MCSA30T30300B*	1750	3	13300	78
	MCSA30T10500B	MCSA30T30500B*	1750	5	18200	82
	--	MCSA36T30200C*	1140	2	14000	76
42"	--	MCSA36T30300C*	1140	3	19400	77
	MCSA36T10500B	MCSA36T30500B*	1750	5	16200	78
	MCSA36T10750B	MCSA36T30750B*	1750	7 1/2	21500	85
	--	MCSA42T30200D*	860	2	19200	73
48"	--	MCSA42T30300D*	860	3	23210	75
	--	MCSA42T30500C*	1140	5	25500	79
	--	MCSA42T30750C*	1140	7 1/2	30690	81
	--	MCSA42T31000B*	1750	10	26700	86
	--	MCSA48T30500D*	860	5	29820	78
48"	--	MCSA48T30750D*	860	7 1/2	35700	80
	--	MCSA48T31000C*	1140	10	39500	84
	--	MCSA48T31500C*	1140	15	47300	86

## DIMENSIONS

FAN SIZE	A	B	C	D	E (Tube I.D.)	F
18"	30 1/2"	30 1/4"	58 2/3"	21"	18 3/8"	17 4/7"
24"	36 1/2"	30 1/4"	61 2/3"	21"	24 3/8"	23 4/7"
30"	42 1/2"	30 1/4"	64 2/3"	21"	30 3/8"	29 4/7"
36"	--	--	67 2/3"	27"	36 3/8"	--
42"	--	--	70 2/3"	32"	42 3/8"	--
48"	--	--	73 2/3"	32"	48 3/8"	--

Side View

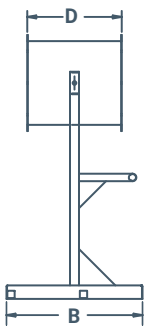

Front View

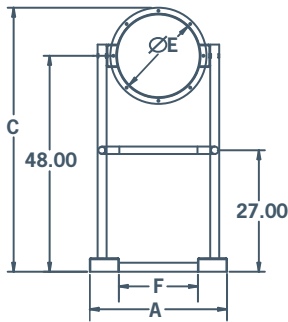

For three phase motors, substitute "" with "M" for 230/460 volt (if 208V required please specify) or "P" for 575 volt  
dBA ratings shown are measured at 0" static pressure and should be used as a guideline only.

## OPTIONS

- Junction box installed on the outside of the fan body.