

KE SERIES

Direct Drive Radial Blade Blower for high static applications, greenhouse inflation or exhaust.

Ideal for environments where air is laden with dust, grit or any other lightweight foreign material.



FEATURES

- Wheels are constructed of heavy cast aluminum with straight radial blades.
- Wheels are self cleaning, dynamically balanced and designed for efficient operations.
- Welded 16 gauge steel housings and motor bases.
- TEFC motors are standard.
- Comes as clockwise rotation, bottom horizontal discharge (can be rotated at 45° increments).

PERFORMANCE SPECIFICATIONS

MODEL						CFM @ STATIC PRESSURE														dBA @ 5 FT
SINGLE PHASE	THREE PHASE 208/230/460	THREE PHASE 575	HP	MOTOR FRAME	RPM	0"	1/8"	1/4"	3/8"	1/2"	5/8"	3/4"	1"	1 1/4"	1 1/2"	1 3/4"	2"	2 1/4"		
KE-08S	KE-08M	KE-08P	1/6	56	1725	533	493	448	396	334	250	93	--	--	--	--	--	--	64	
KE-09S	KE-09M	KE-09P	1/4	56	1725	909	848	788	724	655	572	462	--	--	--	--	--	--	69	
KE-11S	KE-11M	KE-11P	3/4	56	1725	1593	1524	1457	1386	1309	1225	1134	916	617	97	--	--	--	75	
KE-12S	KE-12M	KE-12P	1 1/2	56	1725	2461	2400	2330	2257	2179	2096	2007	1807	1564	1252	812	166	--	79	
KE-14S	KE-14M	KE-14P	2	145T	1725	3393	3307	3221	3134	3046	2956	2863	2664	2438	2164	1786	1181	666	81	

EXPLOSION PROOF DIRECT DRIVE RADIAL BLADE BLOWERS

KE-08SX	KE-08MX	KE-08PX	1/6	56	1725	533	493	448	396	334	250	93	--	--	--	--	--	--	64
KE-09SX	KE-09MX	KE-09PX	1/4	56	1725	909	848	788	724	655	572	462	--	--	--	--	--	--	69
KE-11SX	KE-11MX	KE-11PX	3/4	56	1725	1593	1524	1457	1386	1309	1225	1134	916	617	97	--	--	--	75
KE-12SX	KE-12MX	KE-12PX	1 1/2	56	1725	2461	2400	2330	2257	2179	2096	2007	1807	1564	1252	812	166	--	79
--	KE-14MX	KE-14PX	2	145T	1725	3393	3307	3221	3134	3046	2956	2863	2664	2438	2164	1786	1181	666	81

dBA ratings shown are measured at 0" static pressure, and should be used as a guideline only. Performance certified is for installation type B- free inlet, ducted outlet.

Power Rating (BHP) does not include transmission losses. Performance ratings do not include the effects of appurtenances (accessories).

DIMENSIONS

MODEL	WHEEL	A	B	C	D	E	F	G	H	J	K	L	M*	O	P	R	V	X
KE-08	7 3/4" x 4"	11"	8"	8 1/4"	5 3/8"	5"	7"	1/2"	6"	4 5/8"	6 3/4"	6 7/8"	10 3/4"	3 3/4"	8"	8"	-	8 1/2"
KE-09	9" x 5"	12 1/8"	8"	10 3/4"	6 1/2"	5 5/8"	7"	1/2"	6 3/4"	5 5/8"	7 3/4"	7 1/8"	11 3/4"	4 5/16"	9"	9 1/4"	-	9 3/8"
KE-11	10 7/8" x 5 5/8"	14 3/4"	9"	11 3/4"	8"	6 7/8"	7 1/2"	3/4"	8"	6 3/4"	9 1/8"	8 1/8"	13 1/4"	5 1/16"	10"	10 3/4"	-	11 3/4"
KE-12	12 1/2" x 7 1/2"	16 3/8"	10 1/2"	13 1/4"	9 5/8"	7 3/8"	8 3/4"	7/8"	10 1/8"	8 1/2"	11 1/2"	10 1/2"	15 3/16"	6 3/8"	13 1/4"	13 1/4"	11 1/8"	17"
KE-14	13 1/2" x 8 1/8"	17 5/8"	10 1/2"	14 5/8"	10 3/4"	8"	8 3/4"	7/8"	11 1/8"	9 3/8"	12 5/8"	11 3/8"	16 3/4"	7"	14 1/2"	14 5/8"	12 1/4"	17"

* Dimensions may vary depending on type of motor used.

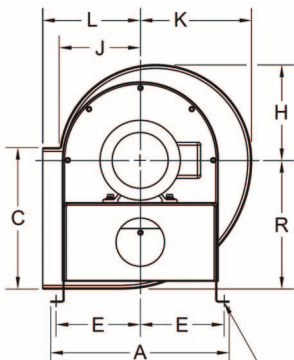

N DIA. 4 HOLES

Clockwise rotation, bottom horizontal discharge shown.

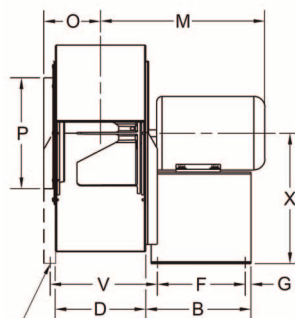

N DIA. 2 HOLES

[Only on Models KE-12 and KE-14]

Mounting holes are 3/8" diameter on all models up to KE-11 and 9/16" on the KE-12 and KE-14.

RELATED PRODUCTS

PW SERIES
Direct Drive Pressure Blowers

